

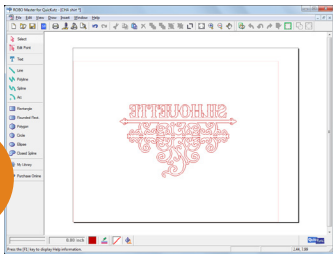

# Silhouette heat transfer material

1



Select a Silhouette design or font and lay out your design in the Silhouette software. Be sure to mirror the image horizontally so text will appear backwards on the screen.

2



Feed the heat transfer material into the Silhouette without a cutting mat with the clear plastic side on the bottom. (Peel up a corner to check which side has the clear plastic transfer sheet.) Use the blue cap and a thickness of 16-18 for smooth heat transfer material, and the pink cap and a thickness of 28-33 for flocked heat transfer material.

3

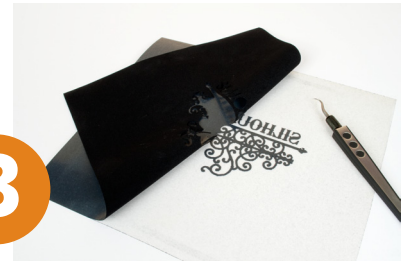

Peel the negative space of the design off the plastic backing leaving only the design you want to transfer on the clear plastic transfer sheet.

4



Position the design on the desired surface face down so that you see it through the clear transfer sheet.

5

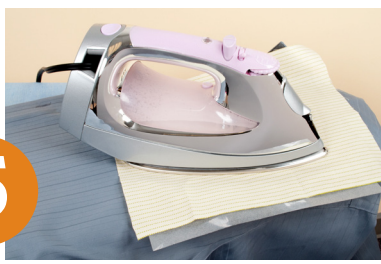

Place a cloth over the design and place a heated iron on top **PRESSING FIRMLY** into the design for 45-60 sec.

6



Remove the iron and cloth and gently peel up the transfer sheet. If the heat transfer material continues to stick to the transfer sheet, replace the cloth and iron again making sure to apply pressure.

7



Your custom clothing design is ready to wear!

Wash and dry clothes inside out.  
Use extreme caution when operating a hot iron.  
Keep out of reach of children.

NOTE: Silhouette heat transfer material will not adhere to nylon.