

1

Select normal print quality and a plain or photo paper setting. Print on the blank side of the transfer paper, one sheet at a time (there is no need to mirror your image or artwork)

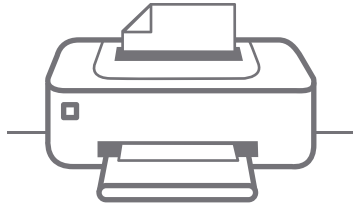

Print on the blank/unprinted side of the transfer paper



2

Trim around or contour cut the image
Note: This paper has a white film background



**SILHOUETTE
BLADE SETTING***

SPEED 3 THICKNESS 2-3

*Adjust as necessary. Use a cutting mat (carrier sheet) and cut through the film layer only

3

Peel the thin printed film layer off the backing paper



4

Pre-heat iron for **3 minutes** on the highest cotton setting



5

Choose a smooth hard surface at waist level



6

Place image face up on substrate and cover with a Teflon or silicone sheet

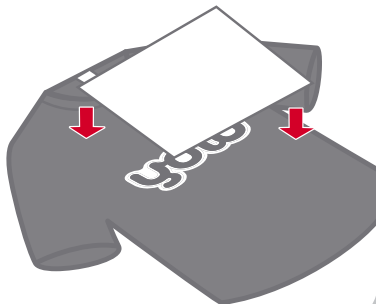

7

Using two hands firmly slide the iron vertically up and down

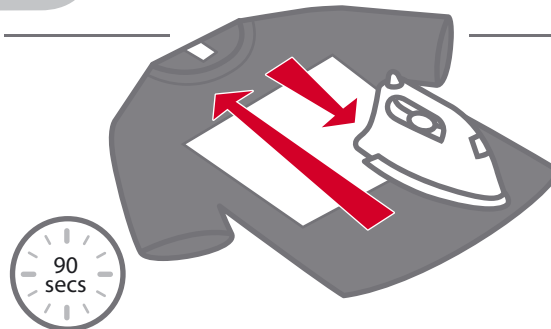

The iron should be halfway off the edge of the transfer when the edges are ironed

In **90 seconds** the iron should make two passes over the surface of the transfer

8

Using two hands firmly slide the iron horizontally side to side

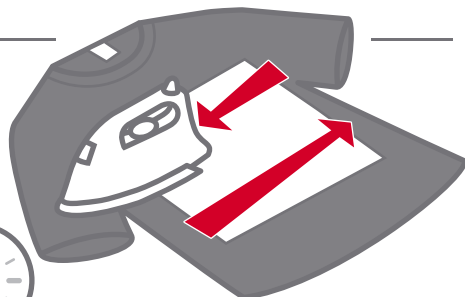

The iron should be halfway off the edge of the transfer when the edges are ironed

In **90 seconds** the iron should make two passes over the surface of the transfer

9



1

Select normal print quality and a plain or photo paper setting. Print on the blank side of the transfer paper, one sheet at a time (there is no need to mirror your image or artwork)



Print on the blank/unprinted side of the transfer paper

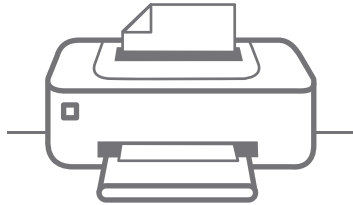

2

Trim around or contour cut the image
Note: This paper has a white film background



SILHOUETTE
BLADE SETTING*

SPEED 3 THICKNESS 2-3

*Adjust as necessary. Use a cutting mat (carrier sheet) and cut through the film layer only

3

Peel the thin printed film layer off the backing paper



4

Prepare the heat press at 175°C / 350°F

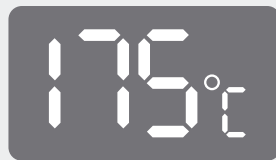

5

Place image face up on substrate and cover with a Teflon or silicone sheet

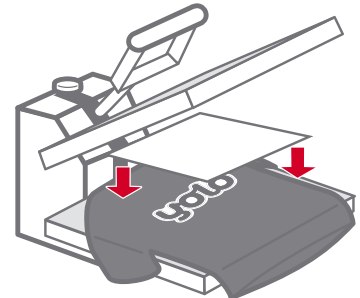

6

Apply **medium to heavy** pressure for 20 - 30 seconds

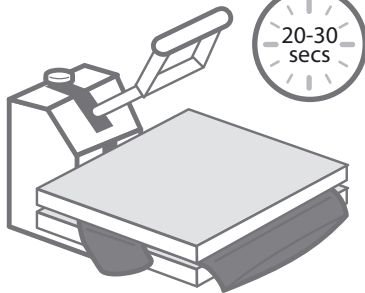

7



yolo tip

Repressing for 5-7 seconds with a Teflon or silicone sheet (remove when cold) to improve adhesion and increase softness and durability

wash and care instructions



Machine wash separately



Dry at low heat setting



Do not dry clean, bleach or directly iron transfer

contact

hello@yolo.co.uk

+44 (0) 2082 400 658

www.yolo.co.uk

Product code: 3GJO

Store in a cool, dry place and seal the packaging between uses

Printed on 100% recycled paper