

1

Mirror your image  
or artwork



2

Run a few sheets of blank paper through the printer to warm it up to operating temperature. Select normal print quality and gradually increase the paper weight setting until the toner fuses well and the image does not smudge\*. Print on the blank side of the transfer paper, one sheet at a time using a bypass tray if possible

\*You may have to use a slow paper setting e.g. heavy paper, transparency or label mode. If in doubt, consult your printer manufacturer.

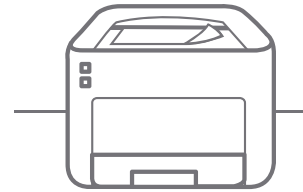
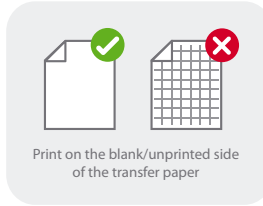

3

Prepare the heat press at  
**170°C / 340°F.**  
Place image face down  
on substrate

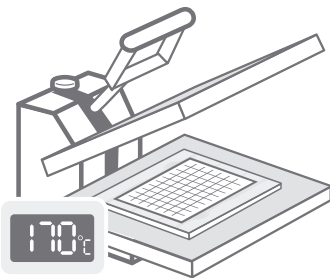

4

Apply **heavy** pressure for  
**40 seconds**

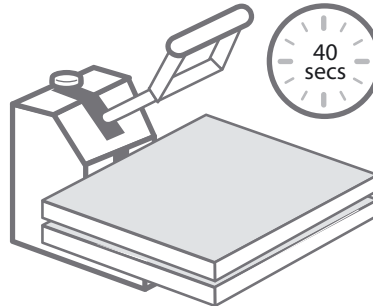

5



Peel  
whilst  
hot

Apply a varnish to  
improve durability

! Store in a cool, dry place and seal the packaging between uses

Product code: **TPEZ**

♥ Printed on 100% recycled paper

contact

✉ hello@yolo.co.uk

☎ +44 (0) 2082 400 658

🌐 www.yolo.co.uk